

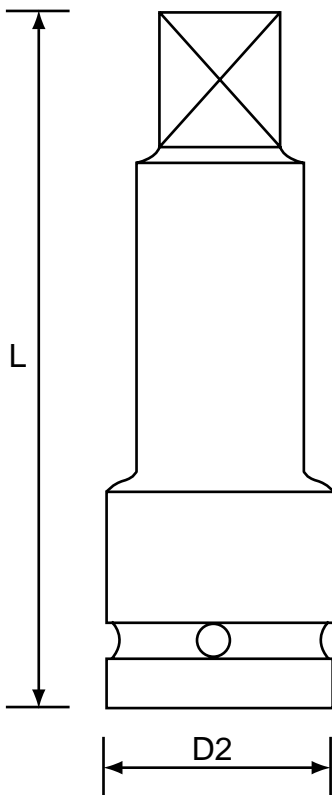

1/4" - 1 1/2" drive

extension bars



inch	inch	Type	D2 mm	L mm	£ Price/Piece
1/4	1/4	BALL	13	50	10.00
1/4	1/4	BALL	13	100	10.00
1/4	1/4	BALL	13	150	10.00
3/8	3/8	BALL	19	75	10.00
3/8	3/8	BALL	19	125	10.00
3/8	3/8	BALL	19	150	11.00
3/8	3/8	BALL	19	250	11.00
1/2	1/2	BALL	25	75	13.00
1/2	1/2	BALL	25	100	13.00
1/2	1/2	BALL	25	125	14.00
1/2	1/2	BALL	25	150	15.00
1/2	1/2	BALL	25	250	19.00
1/2	1/2	BALL	25	300	38.00
1/2	1/2	BALL	25	460	60.00
1/2	1/2	BALL	25	600	80.00
1/2	1/2	BALL	25	900	100.00
3/4	3/4	HOLE	44	75	25.00
3/4	3/4	HOLE	44	100	25.00
3/4	3/4	HOLE	44	125	26.00
3/4	3/4	HOLE	44	150	27.00
3/4	3/4	HOLE	44	200	31.00
3/4	3/4	HOLE	44	250	31.00
3/4	3/4	HOLE	44	300	36.00
3/4	3/4	HOLE	44	400	60.00
1"	1"	HOLE	54	100	36.00
1"	1"	HOLE	54	150	40.00
1"	1"	HOLE	54	200	42.00
1"	1"	HOLE	54	250	44.00
1"	1"	HOLE	54	300	55.00
1"	1"	HOLE	54	400	85.00
1 - 1/2	1 - 1/2	HOLE	86	150	135.00
1 - 1/2	1 - 1/2	HOLE	86	250	220.00
1 - 1/2	1 - 1/2	HOLE	86	500	400.00

impact accessories

adaptors
universal joints
screwdriver adaptors



adapters

1/4 to 1 1/2" drive



female inch	male inch	Type	D2 mm	L mm	£ Price/Piece
1/4	3/8	BALL	13.6	26	25.00
3/8	1/4	BALL	22	32	11.00
3/8	1/2	BALL	22	36	8.00
1/2	3/8	BALL	25	38	8.00
1/2	5/8	PIN	43	43	25.00
1/2	3/4	HOLE	30	48	11.00
1/2	1"	HOLE	33	60	50.00
5/8	1/2	PIN	35	49	25.00
5/8	3/4	HOLE	35	53	25.00
3/4	1/2	BALL	44	56	13.00
3/4	5/8	PIN	44	53	25.00
3/4	1"	HOLE	44	63	16.00
1	3/4	HOLE	54	75	22.00
1	1-1/2	HOLE	54	90	70.00
1-1/2	1	HOLE	86	100	80.00
1-1/2	2-1/2	HOLE	86	120	300.00
2-1/2	1-1/2	HOLE	127	138	450.00

(no warranty on step down type)



universal joints

1/4 to 1 1/2" drive



Drive	Size	D2 mm	D1 mm	L mm	£ Price/Piece
1/4	1/4	BALL	18	43	20.00
3/8	3/8	BALL	24	50	20.00
1/2	1/2	BALL	32	60	22.00
3/4	3/4	HOLE	44	105	54.00
1"	1"	HOLE	54	133	70.00
1-1/2	1-1/2	HOLE	86	182	270.00



screwdriver adaptors

locking pin type



male hex	male square	L mm	£ Price/Piece
1/4	1/4	50	10.00
1/4	1/4	100	12.00
1/4	1/4	150	14.00
1/4	3/8	50	12.00
1/4	3/8	75	14.00
7/16	3/8	75	14.00
7/16	1/2	75	16.00